

Warehouse Kit Installation Guide

Thermostat

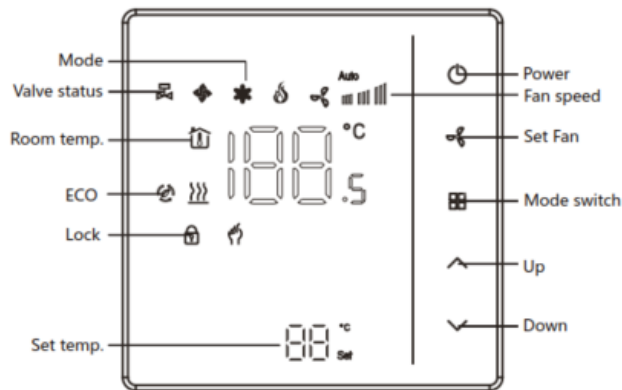

Before Wiring and Installation

- Read these instructions carefully. Failure to follow them could damage the product or cause a hazardous condition.
- Check the ratings given in the instructions and on the product to make sure the product is suitable for your application.
- The installer must be a trained, experienced service technician.
- After installation is complete, check out product operation as provided in these instructions.

Caution

Electrical Shock or Equipment Damage Hazard. Can shock individuals or short equipment circuitry.

Disconnect power supply before installation

Wiring

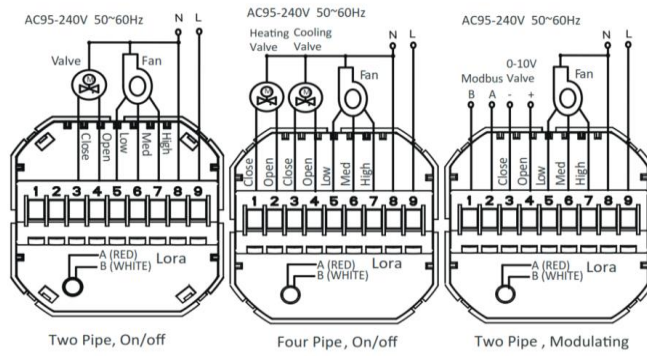

Your thermostat is suitable for installation within a standard 86mm pattress box or European 60mm pattress box.

Step 1. Keep the power off. See Fig 1.

Step 2. Remove the mounting plate by pushing the LED assembly. See Fig 2.



Step 3. Connect power supply, load into the appropriate terminals. (see "Wiring your thermostat" for details and Fig 3).

Step 4. Fix the mounting plate into the wall with screws in the box. See Fig 4.



Step 5. Fix the thermostat body and the mounting plate by the lower button. See Fig 5.

Step 6. Installation complete. See Fig 6.

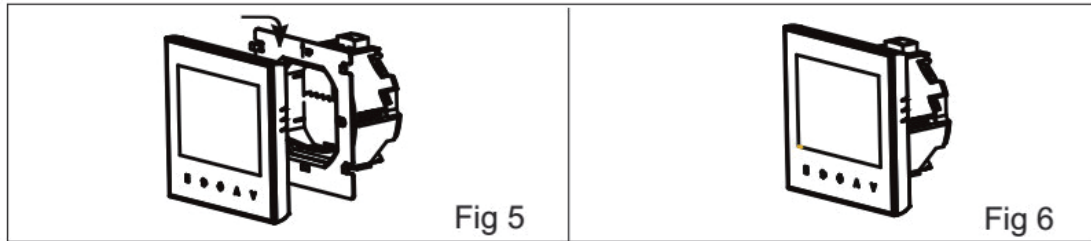

Operation

During Power On

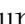
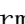

1. Power On/off: Press  to turn the thermostat on/off.
2. Setting Temperature: Press  to set temperature.
3. Locking your Thermostat: Press and hold the  for 5 seconds to lock/unlock your thermostat.

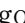
In item 3 of high senior options, you can select full lock or half lock.

4. Selecting System Mode: Press  to change the system mode to HEATING, COOLING and VENTILATION. In VENTILATION mode, the valve is off, but the fan runs.
5. Setting the Fan Speed: Press  go to select the fan speed AUTO, HIGH, MED, LOW.

During Power Off

Setting the functions and options

When the power is off, press and hold  and  at the same time for 5 sec. to reach system function.

The press  to change the different items

All the settings will confirm automatically when the power is on.

Code	Function	Setting and options		Default
1	Temperature compensation	-9 to 9 °C(Internal sensor)		-3
2	Fan control	00:When room temp. reaches the set point,the fan will turn off 01:When room temp. reaches the set point,the fan will keep low speed running(only Auto speed mode)		00
3	Button Locking	00:All buttons are locked except power button. 01:All buttons are locked.		1
4	Mode Select Custom	00:Cooling / Ventilation. 01:Cooling / Heating / Ventilation.		01
5	Min.Set Temp.	5-15°C		5
6	Max.Set Temp.	15-45°C		35
7	Energy-saving Mode	00:Energy saving Mode 01:Non-energy saving Mode		00
8	Heating Energy-saving temperature	10-30°C		20
9	Cooling Energy-saving temperature	10-30°C		26
10	Bright Duty Night	0-7	When set to 0, the device will run for 10 seconds after inactivity. The screen will go completely off with no display.	0
11	Deadzone Temp.	1-5 °C		1
12	on -off of Communication reply	0: OFF. After receiving a command, the terminal would not send a reply command to the server. After uploading data, the terminal would not wait for a reply from the server or resend unreplied data. 1: ON, the terminal will reply normally and wait for the server reply.		0
13	Set the periodic upload of all data	1-60 minute		1
14	Version number			U2

Door and Window Magnetic Detector

Main Device Installation

1. Attach the main device to the wall and mark the two holes in the wall. The connecting line of two holes must be a horizontal line.
2. Drill the holes according to the marks and screw the wall plugs into the wall.
3. Mount the main device to the wall via mounting screws.
4. Cover the mounting screws with screw caps.

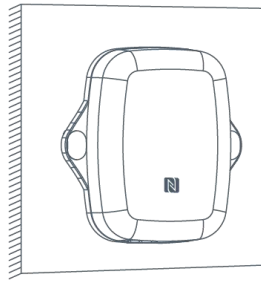
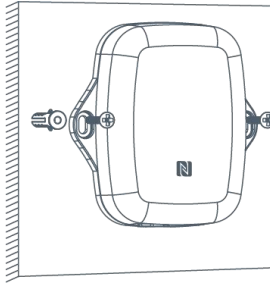

Besides, it can also be mounted to a wall via 3M tape or be mounted to a pole via cable-tie.

Sensor Installation

Fix the two magnet parts with 3M tape or screws, the two parts should be aligned.

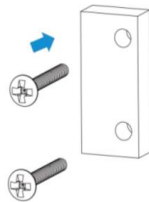

Fixed by Screws

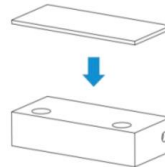

Fixed by 3M Tape

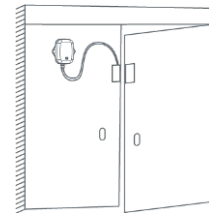

Function	Action	LED Indicator
Door/Window Status	Switch On/Off (network unregistered)	Red, blink once
	Switch On/Off (network registered)	Green, blink once
Network Status	Send join network requests	Red, blink once
	Joined the network successfully	Green, blink twice
Tamper Detection	The device is un-installed (tamper is detected)	Red, blink once
	The device is installed	Green, blink once
Reboot	Press and hold the reset button (internal) for more than 3 seconds	Slowly Blinks
Reset to Factory Default	Press and hold the reset button (internal) for more than 10 seconds	Quickly Blinks

IAQ Sensor

1. Button and LED Indicator

Function	Action	LED Indicator
Power ON/OFF	Press and hold the power button for more than 3 seconds	Power On: Off → On
		Power Off: On → Off
Reset to Factory Default	Press and hold the power button for more than 10 seconds	Quickly Blinks
Check On/Off Status	Quickly press the power button	Light On: Device is on.
		Light Off: Device is off.
CO ₂ Level Indication (AM103/AM103 L Only)	When the CO ₂ concentration exceeds the threshold	Excellent: Blinks
		Polluted: Blinks
		Bad: Blinks

Note: If the LED Indicator is disabled, it will not show air quality level indication.

2. Power Supply

Remove the rear cover of device to install the batteries, do not reverse the direction of batteries when installing.

Note: The device can only be powered by ER14505 Li-SOC12 batteries not alkaline batteries.

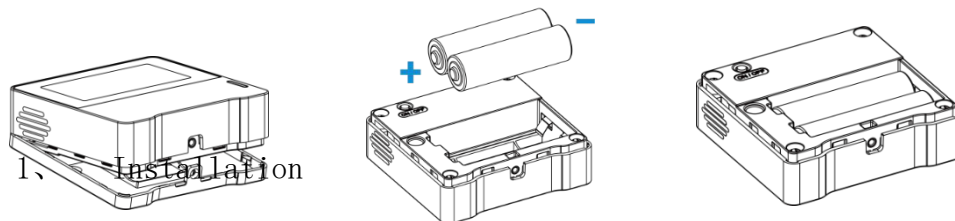

Fixed by Screws:

- a) Remove the rear cover of the device, screw the wall plugs into the wall and fix the rear cover with screws on it, then install back the device.

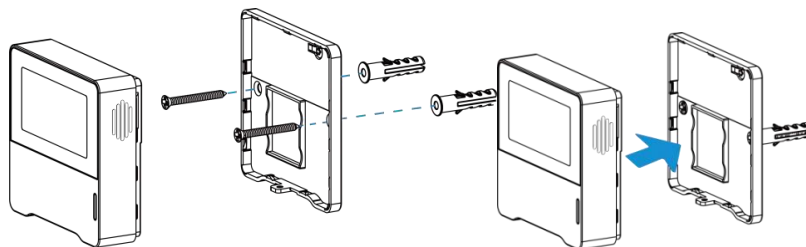

- b) Fix the bottom of the device to the rear cover with the theft-detering screw.

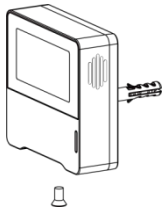

Fixed by 3M Tape:

- a) Fix the bottom of the device to the rear cover with the theft-detering screw.



- b) Paste 3M double-sided tape to the back of the device, then tear the other side and place it on a flat surface.

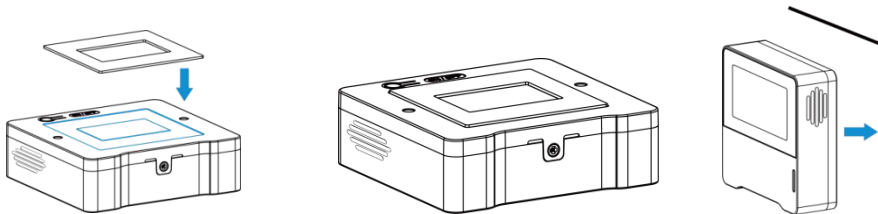

Note:

To ensure the best detection and LoRaWAN[®] communication work, it is recommended to install device as follows:

- Do not mount the device where the temperature is below/above operating range and temperature varies greatly.
- Stay far away from any heat source or cold source like oven, refrigerator.
- Do not mount the device close to where airflow varies greatly like windows, vent, fan and air conditioner.
- Do not mount the device upside down.
- Do not place the device right to the window or door. If you must, you' d better pull the curtain.
- It is recommended to install it at least 1.5 m high from the floor.

Fire & Smoke Alarm

In general, the protection area is 60m² when the alarm space is under 6m high. So, the alarm should be mounted on the ceiling.

- First step, attach the alarm base to the selected mounting location on the ceiling, mark the ceiling with a pencil along the base mounting holes, remove the bottom case, punch two holes in the center of the marks, and secure the alarm base with expansion plugs and tapping screws.
- Second step, press and hold the small cylinder at the bottom of the alarm to turn it on, then press and hold the "TEST" button. If the light flickers rapidly and sounds, the alarm is working. If it's not working, check the battery.
- Third step, test the alarm. Then, rotate it counterclockwise to the base and fasten it. Screw the base with 1.7*6KA screws. Press the "TEST" button. The alarm should sound and flash.

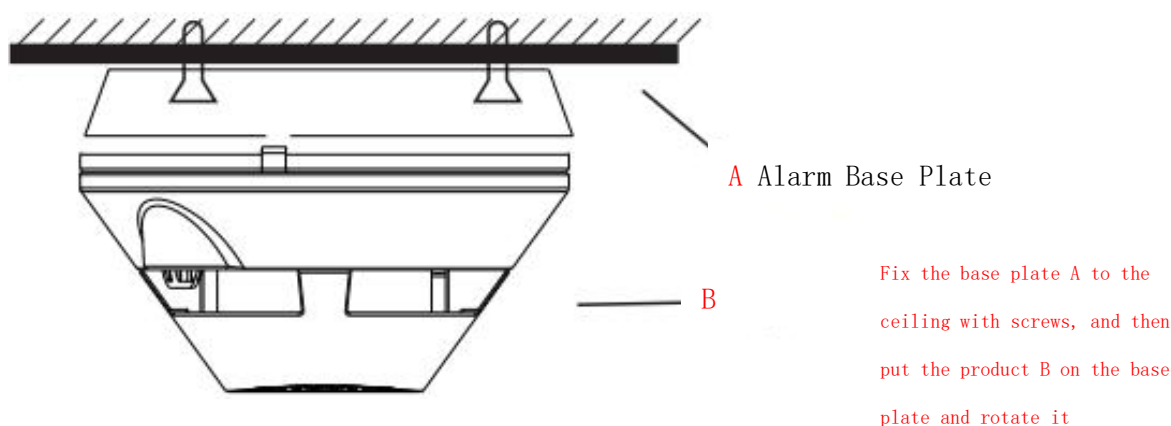

Operation Instruction

- 1. Normal status:** The alarm works when the batteries are installed correctly and the red LED flashes once every 340seconds.
- 2. Self-Checking Status:** Press and hold the "TEST" button. The red LED will flash, and the alarm will issue three beeps. Then, the alarm will sound again after about 1.5 seconds. Release the button to resume normal monitoring.
- 3. Failure Status:** If the alarm beeps for about 45 seconds, it means the battery is low. Replace it with new batteries to keep the alarm working properly.
- 4. Alarm Status:** When the smoke reaches a certain level, the alarm will sound and flash.
- 5. Alarm Memory Status:** The alarm stops when the smoke clears and the green LED flashes three times a minute. The alarm will automatically

turn off after 24 hours to save power. Or you can press and hold the "TEST" button. Then the green light flashes, the alarm makes a short sound, and the button is released. The alarm will exit the memory state.

6. Muting Status: In alarm mode, press the "TEST" button once to mute the alarm. The red LED will flash once every 10 seconds. After about 70 seconds, the alarm will exit the muting status. And the alarm will sound again if there's more smoke.

Failure Analysis and Troubleshooting

1. The alarm sounds for 45 seconds when the battery is low. Please replace the battery.
2. Frequent false alarms: There may be too much dust in the sensor. You'd better clean the external black plastic part with a vacuum cleaner.
3. The "TEST" button does not respond: Check if the alarm is installed correctly. If it still doesn't respond, contact the after-sales team.

Maintenance

If you have any problems, please contact the after-sales team. Do not disassemble or repair it yourself.

Test the alarm once a month by pressing the "TEST" button. If there's a fault, please fix it in a timely manner.

Gateway

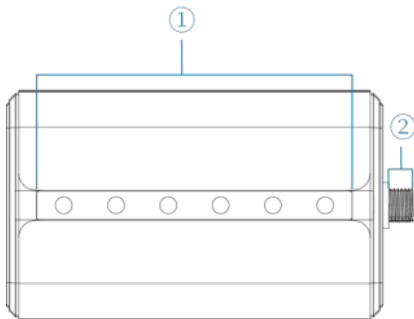

① LED Indicator Light: Power / Status / LoRa / WiFi / LTE/ ETH

- ② LoRa Antenna Interface (only external antenna version supports)
- ③ Bracket fixing screws
- ④ SIM card slot
- ⑤ Type-C debug serial port
- ⑥ Ethernet port (POE)
- ⑦ Power interface
- ⑧ Reset button
- ⑨ Silicone wire guide
- ⑩ Wire duct

LED Indicator Introduction

LED Type	Indicator	Status	Description
Power	Power status	off	Power off
		blue light	Constant light: power connected
status	System status	blue light	Constant light: System is operating normally
		red light	System Error
LoRa	LoRa status	off	Packet forwarding mode inactive
		blue light	Packet forwarding mode active

WiFi	WiFi status	off	Wi-Fi prohibited
		blue light	Wi-Fi allowed
LTE	Cellular status	off	SIM card is being registered or registration failed (or SIM card is not inserted)
		blue light	Slow flashing: SIM card has been successfully registered and is ready to dial
			Fast flashing: SIM card has been successfully registered and dialing
			Instant light: SIM card has been successfully registered and dialing
ETH	Network interface status	off	Not connected or disconnected
		blue light	Instant light: Connected

Restoration Button

Function	Description	
	Light Status	Operation Guidance
Reset to the factory settings	Constant light	Press and hold the restoration button for more than 5 seconds
	Blue constant light → flickering	Release the button and wait
	Off → constant light	Restore gateway to factory settings

SIM Card Installation

- 1.用螺丝刀拆下 UG65 后面板的保护盖。
- 2.将 SIM 卡根据指示方向按入卡槽，取出时向内按压 SIM 卡即可弹出。

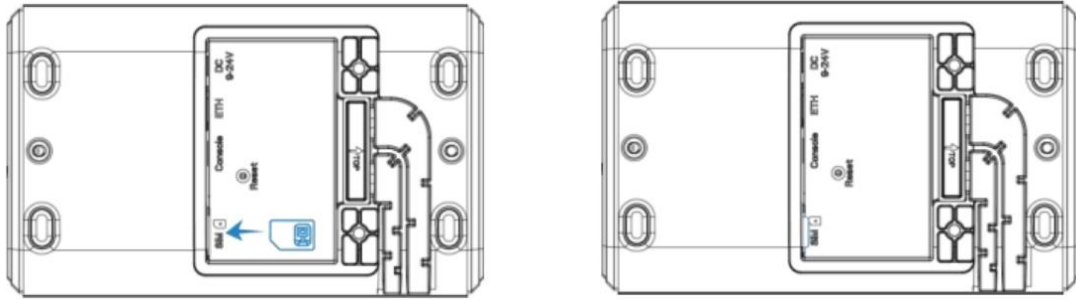

电源和网线接入

1. 将电源适配器接入电源接口，网线接入网口。
2. 将电源线和网线穿过过线硅胶后延伸到下面的凹槽。（硅胶需按标识撕开）
3. 将防护盖装回设备上。

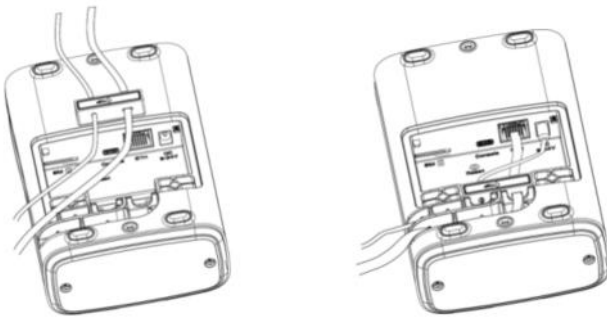

网关同时支持通过接入 PoE 供电或直接接入 PoE 以太网设备供电（PoE 交换机等）。

注意：上电时必须先将网关端的网线接好再接 PoE 供电设备，否则可能损坏 PoE 供电设备或网关。

天线安装

将天线旋进天线接口，天线一般朝上

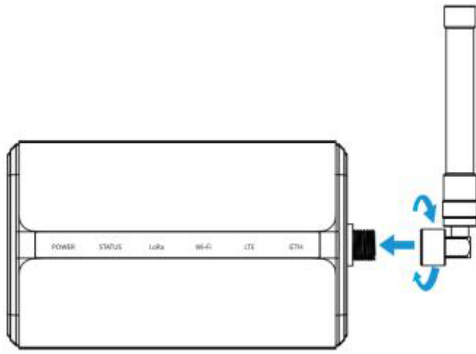

Installation

网关支持桌面放置、壁挂式安装或抱杆式安装。安装前请将设备配置好。

壁挂式安装

安装配件：安装板，支架固定螺丝（2 个），接地螺丝（1 个），膨胀螺栓和壁挂螺丝（4 组）以及其他辅助工具。

1. 安装前请确保 SIM 卡、电源线、网线以及天线已装配完毕，防护盖已锁好。

注意：安装时请勿将设备上电或对接其它设备。

2. 将安装板平移到墙上目标位置，用记号笔在墙上标记 4 个螺钉孔的位置后（相邻孔位连线应垂直），将安装板移除。

3. 用 6 毫米钻头的电钻在墙上标记的螺钉孔上钻 4 个 32 毫米深的钻孔。

4. 将 4 个膨胀螺栓钉进 4 个钻孔中。

5. 将安装板用壁挂螺丝固定到膨胀螺栓上。

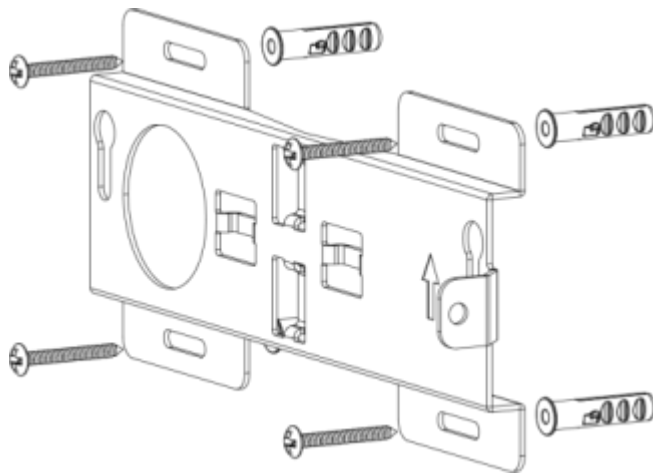

6. 将支架固定螺丝锁到设备后面板上，然后将设备挂到墙上的安装板。

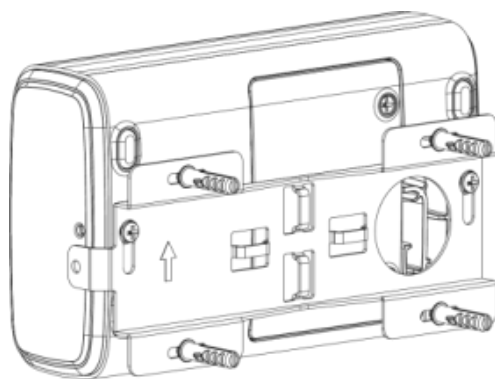

7. 将接地螺丝穿过安装板锁到设备上。

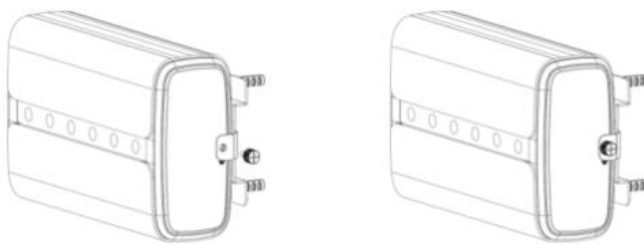

抱杆式安装

安装配件：安装板，支架固定螺丝（2 个），接地螺丝（1 个），抱箍和其他辅助工具。

1. 安装前请确保 SIM 卡、电源线、网线以及天线已装配完毕，防护盖已锁好。

注意：安装时请勿将设备上电或对接其它设备。

2. 逆时针拧开抱箍的锁固。
3. 将抱箍拉直并穿进安装板上的环上，然后将抱箍绕到目标杆上。
4. 用螺丝刀顺时针拧紧抱箍上的锁固。

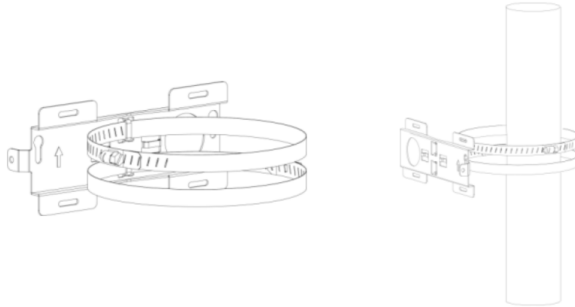

5. 将支架安装螺丝锁到设备后面板，然后将设备挂到杆上的安装板。
6. 将设备上的接地螺丝穿过安装板锁到设备上。

