

Office Climate Comfort Kit

Installation Guide

Table of Contents

Thermostat.....	1
Door and Window Magnetic Detector.....	5
60GHz Occupancy Sensor	6
IAQ Sensor	7
Gateway.....	9

Thermostat

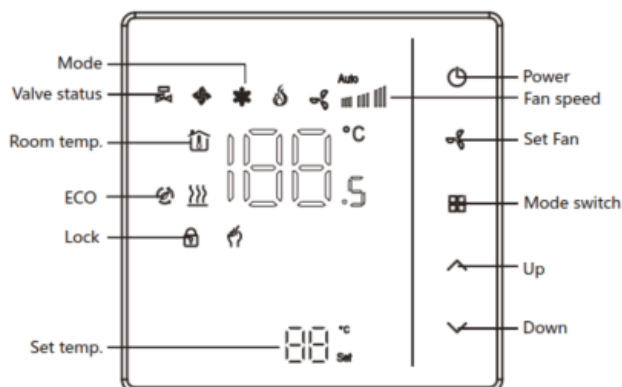

Pre-installation Precautions

1. Read these instructions carefully. Failure to follow them could damage the product or cause a hazardous condition.
2. Check the ratings given in the instructions and on the product to make sure the product is suitable for your application.
3. The installer must be a trained, experienced service technician.

4. After installation is complete, check out product operation as provided in these instructions.

CAUTION

1. Electrical Shock or Equipment Damage Hazard. Can shock individuals or short equipment circuitry.
2. Disconnect power supply before installation

Wiring

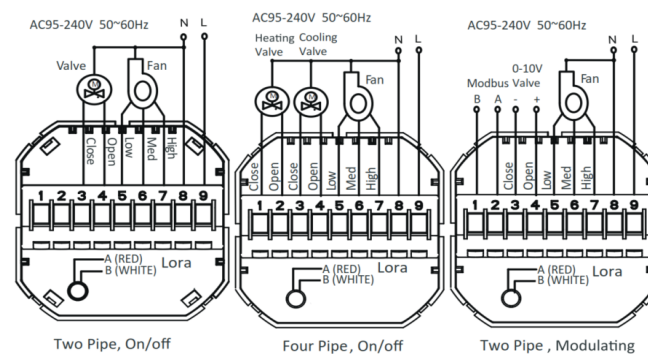

Your thermostat is suitable for installation within a standard 86mm pattress box or European 60mm pattress box.

Installation

1. Keep the power off. See Fig 1.
2. Remove the mounting plate by pushing the LED assembly. See Fig 2.



3. Connect power supply, load into the appropriate terminals. (see "Wiring your thermostat" for details and Fig 3).

4. Fix the mounting plate into the wall with screws in the box. See Fig 4.

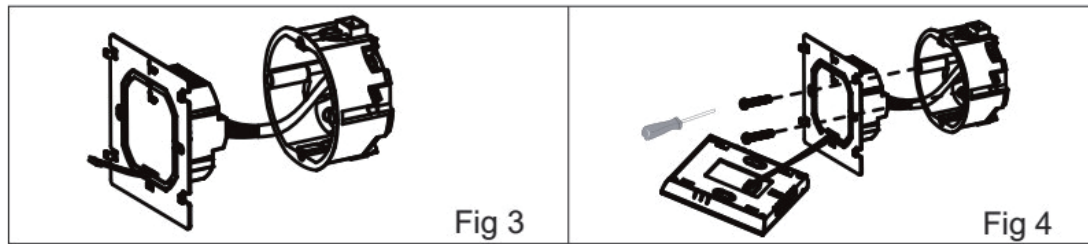



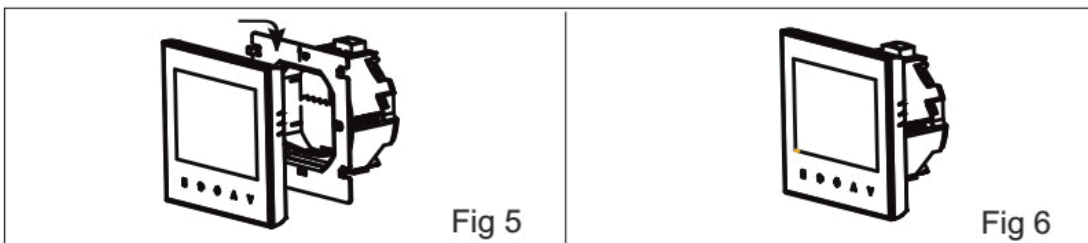

5. Fix the thermostat body and the mounting plate by the lower button. See Fig 5.
6. Installation complete. See Fig 6.





Operation

1. During Power On

- 1) Power On/off: Press  to turn the thermostat on/off.
- 2) Setting Temperature: Press  to set temperature.
- 3) Locking your Thermostat: Press and hold the  for 5 seconds to lock/unlock your thermostat.
- 4) In item 3 of high senior options, you can select full lock or half lock.
- 5) Selecting System Mode: Press  to change the system mode HEATING, COOLING and VENTILATION. In VENTILATION mode, the valve is off, but the fan runs.
- 6) Setting the Fan Speed: Press  go to select the fan speed AUTO, HIGH, MED, LOW.

2. During Power Off

- 1) Setting the functions and options

- 2) When the power is off, press and hold  and  at the same time for 5 sec. to reach the system function.
- 3) The press  to change the different items
- 4) All the settings will confirm automatically when the power is on.

Code	Function	Setting and options		Default
1	Temperature compensation	-9 to 9 °C (Internal sensor)		-3
2	Fan control	00:When room temp. reaches the set point,the fan will turn off 01:When room temp. reaches the set point,the fan will keep low speed running(only Auto speed mode)		00
3	Button Locking	00:All buttons are locked except power button. 01:All buttons are locked.		1
4	Mode Select Custom	00:Cooling / Ventilation. 01:Cooling / Heating / Ventilation.		01
5	Min.Set Temp.	5-15°C		5
6	Max.Set Temp.	15-45°C		35
7	Energy-saving Mode	00:Energy saving Mode 01:Non-energy saving Mode		00
8	Heating Energy-saving temperature	10-30°C		20
9	Cooling Energy-saving temperature	10-30°C		26
10	Bright Duty Night	0-7	When set to 0, the device will run for 10 seconds after inactivity. The screen will go completely off with no display.	0
11	Deadzone Temp.	1-5 °C		1
12	on -off of Communication reply	0: OFF. After receiving a command, the terminal would not send a reply command to the server. After uploading data, the terminal would not wait for a reply from the server or resend unreplied data. 1: ON, the terminal will reply normally and wait for the server reply.		0
13	Set the periodic upload of all data	1-60 minute		1
14	Version number			U2

Door and Window Magnetic Detector

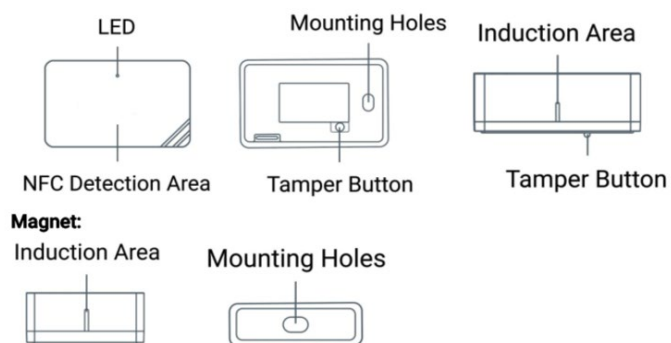

LED and Button Patterns

Function	Action	LED Indicator
Door/Window Status	Switch On/Off (network unregistered)	Red, blink once
	Switch On/Off (network registered)	Green, blink once
Network Status	Send join network requests	Red, blink once
	Joined the network successfully	Green, blink twice
Tamper Detection	The device is un-installed (tamper is detected)	Red, blink once
	The device is installed	Green, blink once
Reboot	Press and hold the reset button (internal) for more than 3 seconds	Slowly Blinks
Reset to Factory Default	Press and hold the reset button (internal) for more than 10 seconds	Quickly Blinks

Installation

1. 3M Tapes Fix

Tear the 3M tapes of both parts, then make sure the magnet part is placed inside the door (portable part) and sensor is inside the door frame (fixed part). For double doors, put every part on each door.

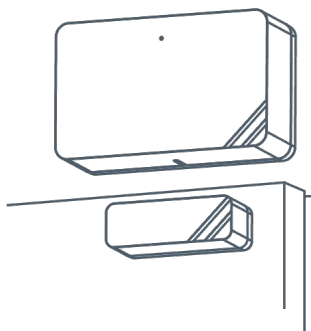

2. Screw Fix

Remove the cover of both parts, screw the covers on the mounting positions, then install back the devices.

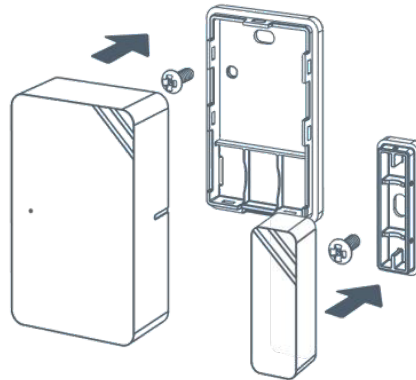

Note

- The notch side of magnet should face the notch side of sensor, otherwise it may affect the sensitivity of on/off detection.
- The plane distance between sensor and magnet should not be more than 15mm, and the height difference should be less than 7.5 mm.

60GHz Occupancy Sensor

Installation

Step1: Screw in the ceiling based on the installation direction.

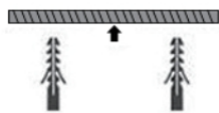

Step2: Fix the back cover to the ceiling with screws.

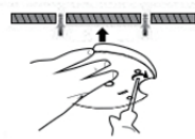

Step3: Install the body clockwise on the back cover clips, then tighten it.



Note

- Top mounted. Firstly, screw the base to the wall before hanging the body on the base. The installation height should be no less than 2 meters.

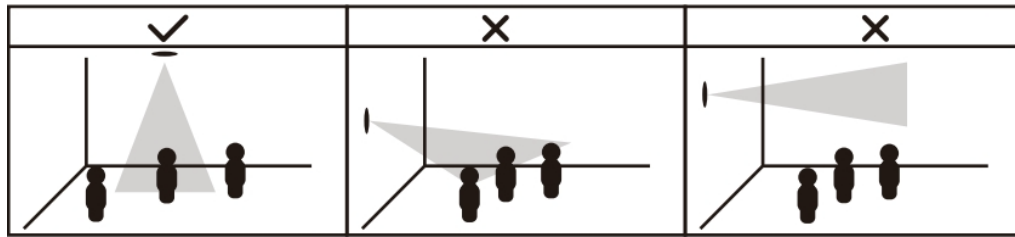

- Installation direction marking on the base, please adjust the appropriate angle according to the actual demand.

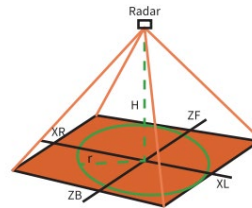

Default occupancy detection range

- Height: 250cm (2.5m)
- Left and right distance: 900cm
- Front and back distance: 900cm

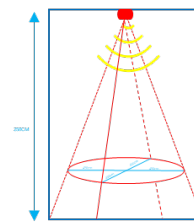

IAQ Sensor

Button and LED Indicator

Function	Action	LED Indicator
Power ON/OFF	Press and hold the power button for more than 3 seconds	Power On: Off → On
		Power Off: On → Off
Reset to Factory Default	Press and hold the power button for more than 10 seconds	Quickly Blinks
Check On/Off Status	Quickly press the power button	Light On: Device is on.
		Light Off: Device is off.
CO ₂ Level Indication (AM103/AM103 L Only)	When the CO ₂ concentration exceeds the threshold	Excellent: Blinks
		Polluted: Blinks
		Bad: Blinks

Note: If the LED Indicator is disabled, it will not show air quality level indication.

Power Supply

Remove the rear cover of device to install the batteries, do not reverse the direction of batteries when installing.

Note: The device can only be powered by ER14505 Li-SOCl₂ batteries not alkaline batteries.

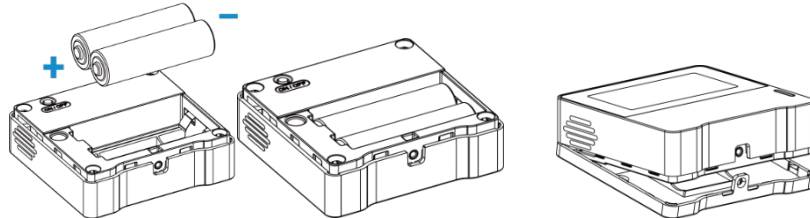

Installation

1. Fixed by Screws

- a) Remove the rear cover of the device, screw the wall plugs into the wall and fix the rear cover with screws on it, then install back the device.

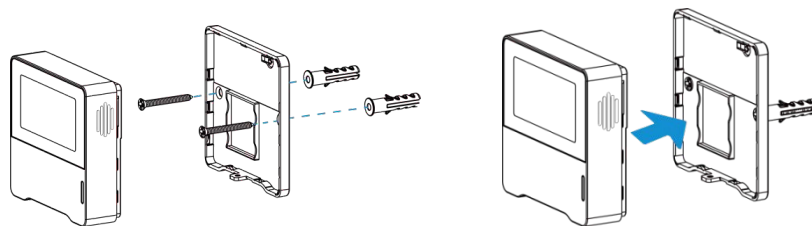

- b) Fix the bottom of the device to the rear cover with the theft-detering screw.

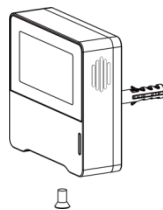

2. Fixed by 3M Tape

- a) Fix the bottom of the device to the rear cover with the theft-detering screw.

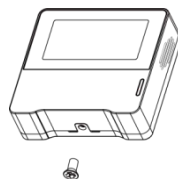

- b) Paste 3M double-sided tape to the back of the device, then tear the other side and place it on a flat surface.

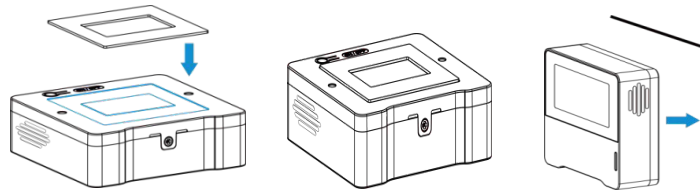

Note

To ensure the best detection and LoRaWAN® communication work, it is recommended to install device as follows:

- Do not mount the device where the temperature is below/above operating range and temperature varies greatly.
- Stay far away from any heat source or cold source like oven, refrigerator.
- Do not mount the device close to where airflow varies greatly like windows, vent, fan and air conditioner.
- Do not mount the device upside down.
- Do not place the device right to the window or door. If you must, you'd better pull the curtain.
- It is recommended to install it at least 1.5 m high from the floor.

Gateway

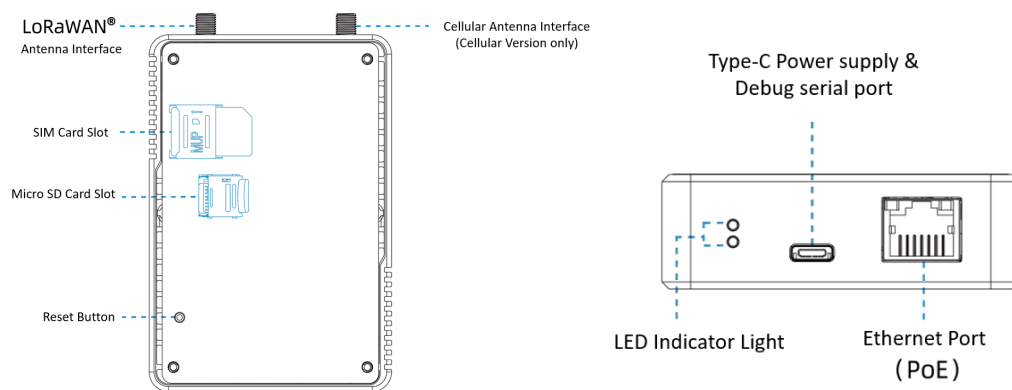

LED Instruction

LED Type	Indicator	Status	Description
----------	-----------	--------	-------------

SYS	System status	off	The system is booting up
		Green light	Constant light: System is operating normally
		Red light	System error
LoRa	LoRa status	off	Packet forwarding mode inactive
		Green light	Packet forwarding mode active
ETH	Link status (orange light)	off	Not connected/ Disconnect
		Constant light	Connected
		flickering	Data is transmitting
	Data transmission status (green light)	Constant light	100 Mbps mode
		off	Other transmission rate mode

Restoration Button

Function	Description	
	Light Status	Operation Guidance
Reset to the factory settings	Constant light	Press and hold the restoration button for more than 5 seconds
	Green constant light → flickering	Release the button and wait
	Off → constant light	Restore gateway to factory settings

SIM Card & Micro SD Card Installation

Remove the top cover of the device by loosening the screws and insert the SIM card or Micro SD card into the corresponding slot.

Caution: The gateway does not support hot unplugging, please power off the device before unplugging the card.

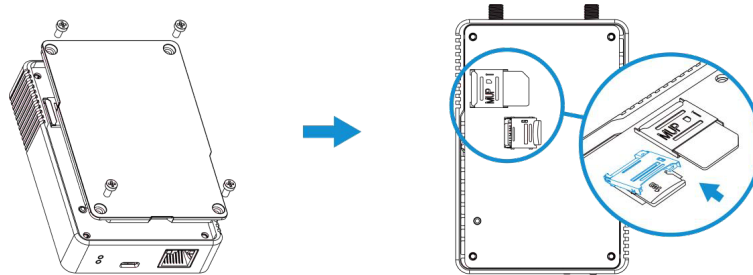

Antenna Installation

Screw the LoRa® antenna or cellular antenna into the antenna connector.

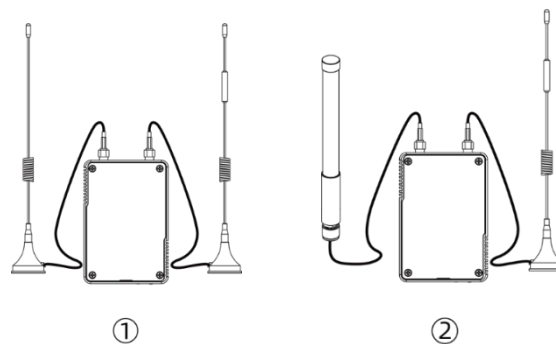

Caution: The antenna should be mounted vertically and away from obstacles.

To secure the fiberglass antenna, thread the antenna through the clamp and tighten the screws. Next, U-bolt the antenna clamp to the target rod and secure it in place with nuts, spring washers, and flat washers.

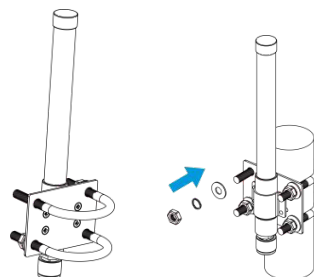

Power Supply

The Gateway support PoE 802.3af standard and can be powered by PoE switch or Type-C 5V. If both Type-C and PoE ports are connected at the same time, the priority is to use the PoE for power supply.

PoE Switch Power Supply

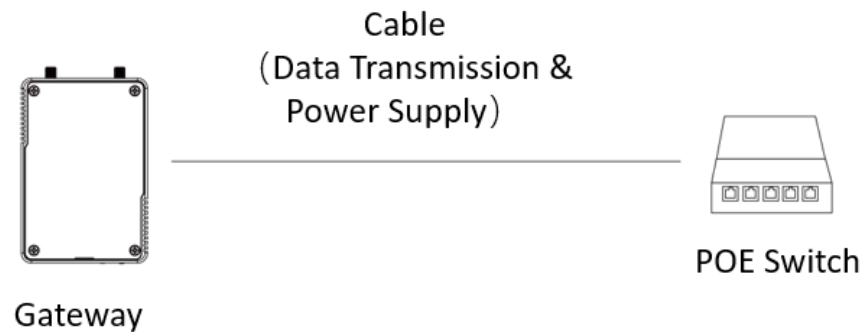

PoE Power Supply

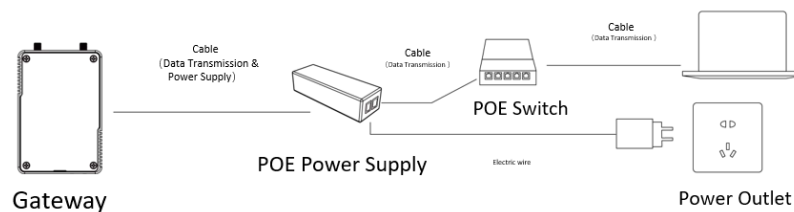

Type-C Power Supply

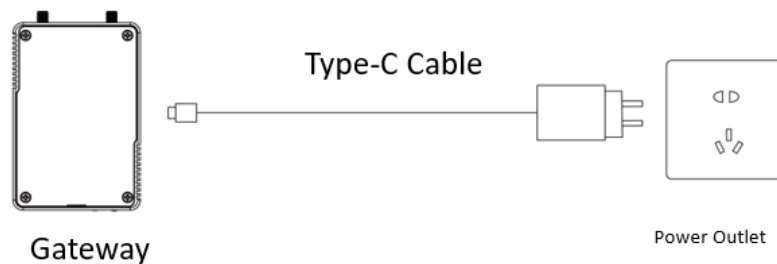

Caution: Before connecting the PoE power supply device, you must first connect the network cable at the gateway end; otherwise, they may be damaged.

Main Device Installation

The device supports desktop placement or wall mounting. Before installation, make sure that the

accessories are fully installed, and the product is configured and powered off.

1. Use two M3 mounting plate fixing screws to fix the plate to the device.

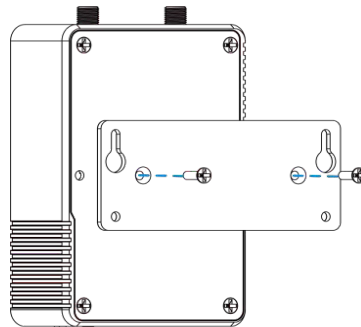

2. Drill 4 holes in the wall according to the holes of the wall mounting plate (the holes are shown as dotted lines in the figure below) and drill the expansion bolts into the wall.
3. Fix the device with the top two M3 wall mounting screws (be careful not to tighten them completely), then secure the remaining 2 screws, and finally fasten them all together.

